

First Floor Plan 1:100

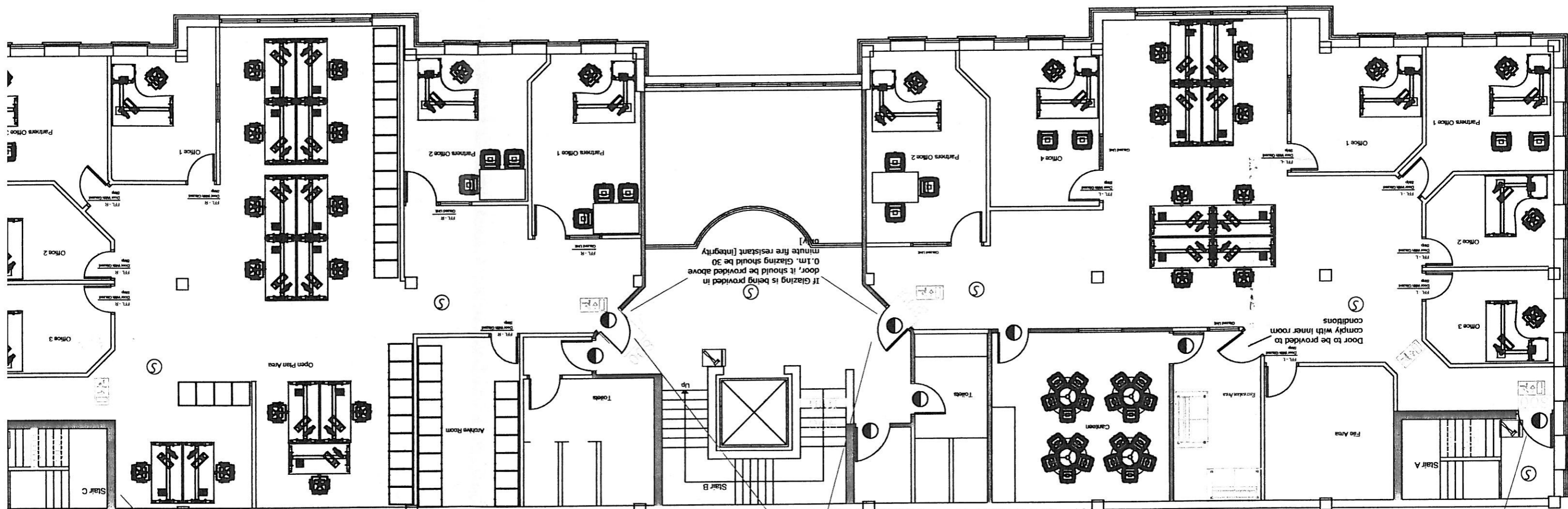

Door to be held open with an electro magnetic hold open device.

If Glazing is to be provided in door or wall enclosing canteen. Glazing is to be provided above 1.1m. Glazing will be 30 minute fire resistant [integrity only]

Door to be held open with an electro magnetic hold open device.

Fire barriers to be carried to the underside of the roof/floor construction and fire stopped

If Glazing is being provided in door, it should be provided with fire resistant [integrity only]

If Glazing is being provided in door, it should be provided above 0.1m. Glazing should be 30 minute fire resistant [integrity only]

Door to be provided to comply with inner room conditions