

- EXISTING DRAWING
- RWP
 - OT
 - ★ STWP
 - MANHOLE
 - AJ

NOTE:
 All dimensions shall be
 confirmed on site.
 In existing plans
 not shown, refer to
 Authority or other
 Authority as applicable.

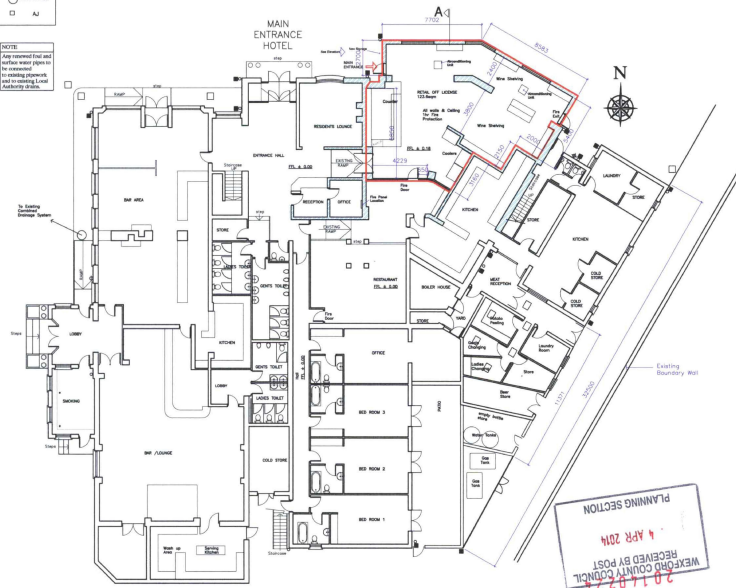

GROUND FLOOR PLAN



FIRST FLOOR PLAN

20140224

EXISTING



ENTRANCE ELEVATION



SECTION A



FRONT ELEVATION



SIDE ELEVATION (West)



SIDE ELEVATION (East)



REAR ELEVATION (South)

WEXFORD COUNTY COUNCIL
 RECEIVED BY POST
 4 APR 2014
 PLANNING SECTION

winkens architecture	Drawing	Existing Floor Plan & Elevations	Date	03.03.2014
	Client	Chan Holdings, Harbour View Hotel, Rosslare Harbour, Co. Wexford	Scale	1:200 (A1)
Whitestown, Drinagh, Wexford p. (053) 912.6605 w. www.winkens.ie e. info@winkens.ie	Project	Change of use from Off license to Amusements, Harbour View Hotel, Rosslare Harbour, Co. Wx	Drawn	zeno winkens
			Drg. No.	1404/CAM/Ex1